

City of Montgomery, Ohio

REDEVELOPMENT STRATEGIES & DESIGN GUIDELINES

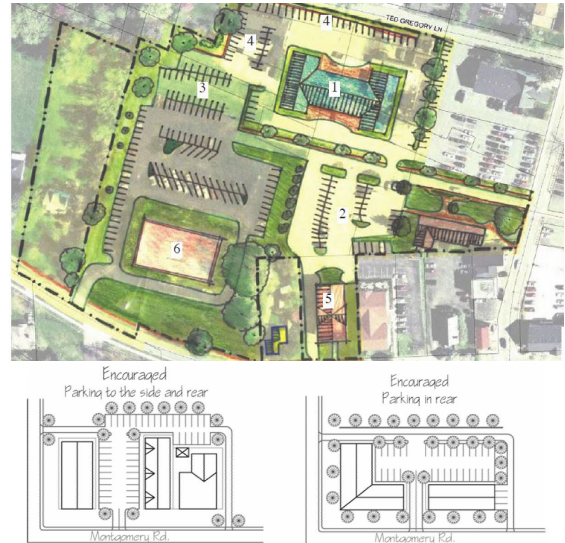

HERITAGE DISTRICT REDEVELOPMENT STRATEGY, SOUTHERN GATEWAY STRATEGY, DESIGN GUIDELINES | 2001-2005

The City of Montgomery, Ohio, is a high end suburb of Cincinnati. The city has a historic core, which contributes to the overall character of the city, and a major commercial corridor, which offers local and regional retail destinations. In 2001, McBride Dale Clarion prepared the Heritage District Redevelopment Strategy which identified key areas for redevelopment and provided guidance to integrate these potential redevelopment projects into the historic fabric of the city.

In 2002, McBride Dale Clarion was retained to assist in the implementation of one of the recommendations of the

Heritage District Redevelopment Strategy, which was the development of a 0.75 acre site. The final plan was taken on by a private developer, which has resulted in a well integrated site that includes parking, a park, and several new businesses.

In 2005, MDC assisted the city with the redevelopment of their southern gateway by creating a new zoning district that would incorporate the historic character of the city with the demand for a regional retail location. Following the adoption of the zoning district, McBride Dale Clarion assisted with the review of development submissions from private developers.

In 2005, McBride Dale Clarion worked with a citizen's steering committee to develop a design guidelines handbook for the Montgomery Road Corridor. The illustrated guidelines include elements such as compatibility with surroundings due to the fact that much of the development activity is redevelopment and infill.

CONTACT INFORMATION

Tracy Roblero
Assistant City Manager
City of Montgomery, OH
P. 513.891.2424
E. troblero@montgomeryohio.org